

TSL-33 不鏽鋼彈簧迫緊式搭扣

Stainless Steel Spring Loaded Draw Latch

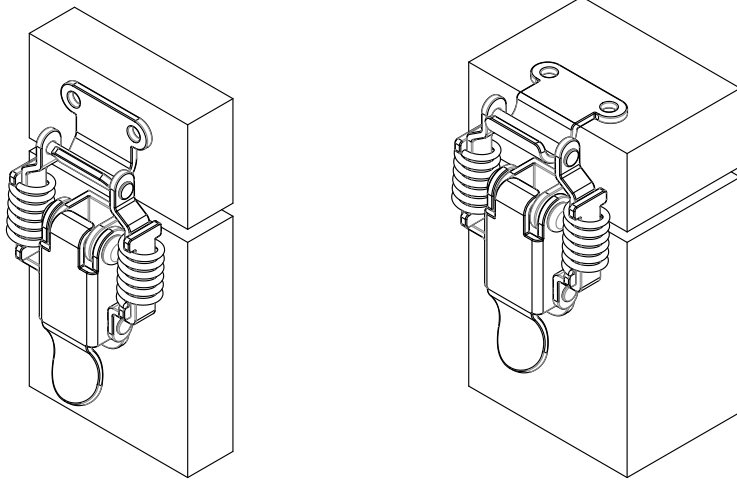

特點 Feature

外裝式彈簧設計可補償設計上或是震動所產生的間隙並迫緊物件。可提供穩定的鎖閉力道。 External spring loaded design compensates for tolerance and vibrations. Provides constant hold tension for secure latching.

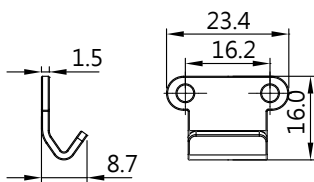
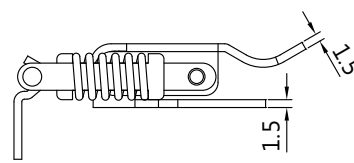
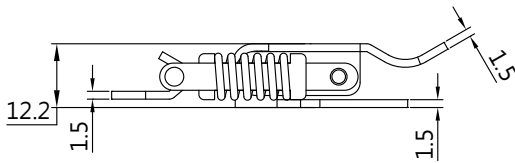
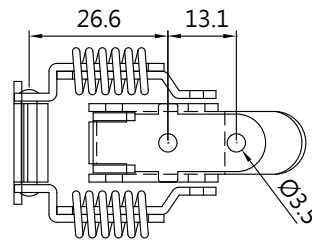
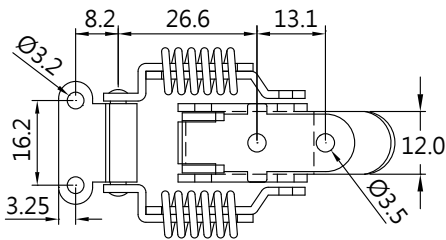

TSL-33-A 水平安裝

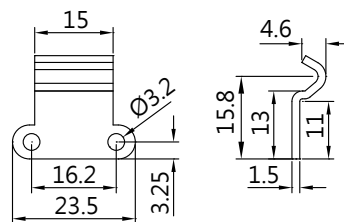

TSL-33-B 垂直安裝

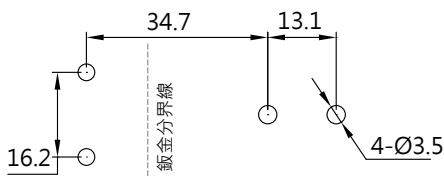

開孔尺寸 CUTOUT

產品型號 Item No.	材質 Material	表面處理 Finish	安裝方式 Installation Type
TSL-33-A	不鏽鋼 304	震動研磨	水平安裝 Standard
TSL-33-B	Stainless Steel 304	Vibration Grind	垂直安裝 Vertical