

TSL-0702 不鏽鋼上偏心型箱扣 Stainless Steel Over-Center Draw Latch



特點 Feature

在嚴苛的環境中提供出色的持久性以及抗腐蝕能力。

Casting, with a fine aesthetic surface, and corrosion-resistance in demanding environments.

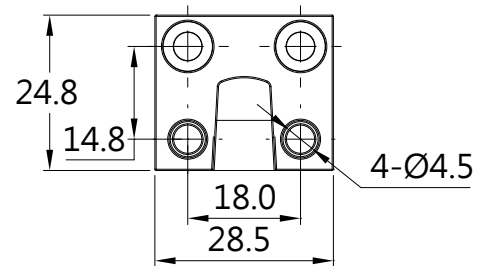
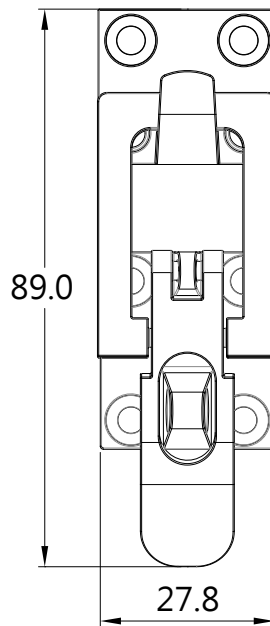
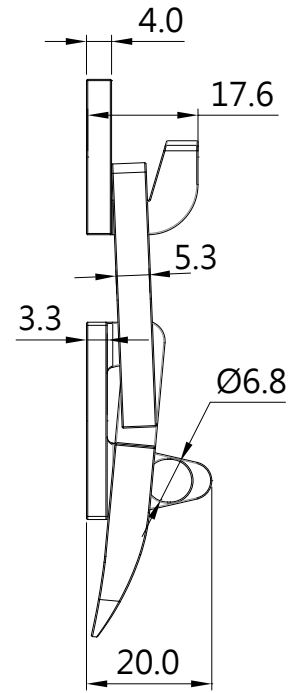
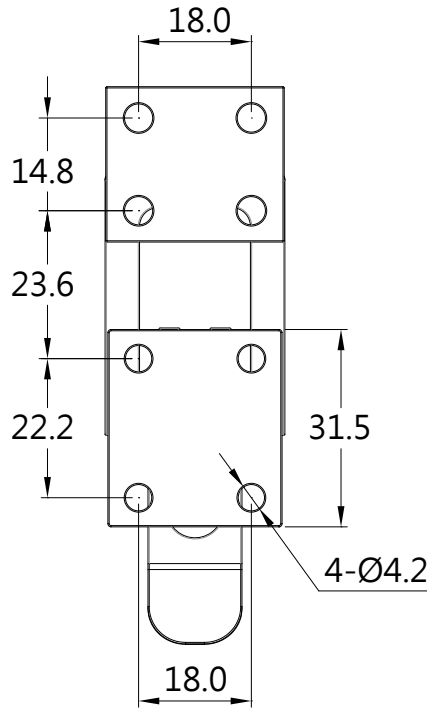

產品型號 Item No.	材質 Material	表面處理 Finish
TSL-0702	不鏽鋼 316 Stainless Steel 316	鏡面拋光 Mirror Surface Buffing