

Type A

Through-hole thread

Threaded blind hole

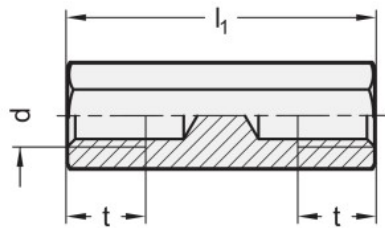
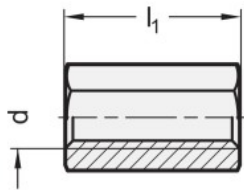

Type B

Application example

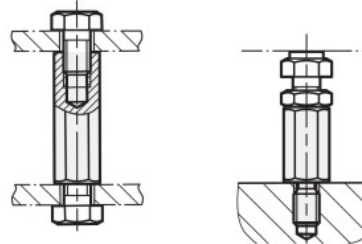
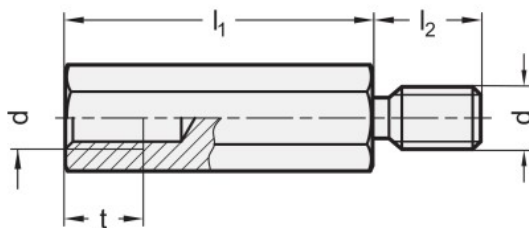

4 Type

- A** Internal thread
- B** Internal thread and threaded stud

2

3

Type A

| d | l ₁ ±0,1 | | | | | | | | | | | | | e ≈ | s | t Min. | |
|-------|---------------------|----|----|----|------|-----|---------------------|----|----|----|----|-----|----|-----|------|-----------|----|
| | Through-hole thread | | | | | | Threaded blind hole | | | | | | | | | | |
| M 2,5 | 5 | 8 | 10 | 12 | 15 | 20 | 25 | 30 | - | - | - | - | - | - | 5,8 | 5 | 7 |
| M 3 | 8 | 10 | 12 | - | 15 | 20 | 25 | 30 | 35 | 40 | 45 | 50 | - | - | 6,4 | 5,5 | 7 |
| M 4 | 10 | 12 | 15 | - | 20 | 25 | 30 | 35 | 40 | 45 | 50 | 60 | 70 | 80 | 8 | 7 | 9 |
| M 5 | 12 | 15 | - | - | 20 | 25 | 30 | 35 | 40 | 45 | 50 | 60 | 70 | 80 | 9,2 | 8 | 10 |
| M 6 | 12 | 15 | - | - | 20* | 25* | 30 | 35 | 40 | 45 | 50 | 60 | 70 | 80 | 11,5 | 10 | 12 |
| M 8 | 15 | 20 | - | - | 25** | 30 | 35 | 40 | 45 | 50 | 60 | 70 | 80 | - | 15 | 13 | 14 |
| M 10 | 25 | 30 | - | - | 35 | 40 | 45 | 50 | 60 | 70 | 80 | 100 | - | - | 19,5 | 17 | 16 |

* t min. = 10, ** t min. = 12

2

3

Type B

| d | l ₁ ±0,1 | | | | | | | | | | | | | e ≈ | l ₂ | s | t Min. |
|------|---------------------|------|-----|----|----|----|----|----|----|-----|----|----|----|------|----------------|-----|-----------|
| | M 2,5 | 8* | 10* | 12 | 15 | 20 | 25 | 30 | - | - | - | - | - | | | | |
| M 3 | 8 | 10 | 12 | 15 | 20 | 25 | 30 | 35 | 40 | 45 | 50 | - | - | 6,4 | 6 | 5,5 | 7 |
| M 4 | 10* | 12** | 15 | 20 | 25 | 30 | 35 | 40 | 45 | 50 | 60 | 70 | 80 | 8 | 8 | 7 | 9 |
| M 5 | 12** | 15 | 20 | 25 | 30 | 35 | 40 | 45 | 50 | 60 | 70 | 80 | - | 9,2 | 8 | 8 | 10 |
| M 6 | 15*** | 20 | 25 | 30 | 35 | 40 | 45 | 50 | 60 | 70 | 80 | - | - | 11,5 | 10 | 10 | 12 |
| M 8 | 20 | 25 | 30 | 35 | 40 | 45 | 50 | 60 | 70 | 80 | - | - | - | 15 | 14 | 13 | 14 |
| M 10 | 25 | 30 | 35 | 40 | 45 | 50 | 60 | 70 | 80 | 100 | - | - | - | 19,5 | 16 | 17 | 16 |

* t min. = 5, ** t min. = 7, *** t min. = 10

Specification

- Steel **ST**
Zinc plated, blue passivated
- Stainless steel AISI 303 **NI**
Matte shot-blasted
- *Stainless Steel Characteristics* → Page 2166
- RoHS

1

Information

Spacers GN 6220 are commonly used as spacing rods. They allow parts to be fastened with an offset parallel to their mounting plane. Type A is also used as a connecting nut.

How to order

| | |
|---|----------------|
| 1 | Material |
| 2 | d |
| 3 | l ₁ |
| 4 | Type |

GN6220-ST-M8-40-A

3.1

3.2

3.3

3.4

3.5

3.6

3.7

3.8

3.9

