

BASE

- **DVA**: zinc-plated steel.
- **DVA-SST**: AISI 304 stainless steel.

VIBRATION-DAMPING BODY

Natural rubber NR, hardness 40, 55, 70 tolerance ±5 Shore A, black colour.

STANDARD EXECUTIONS

- **DVA.6**: zinc-plated steel threaded stud.
- **DVA.6-SST**: AISI 304 stainless steel threaded stud.
- **DVA.7**: zinc-plated steel boss, threaded blind hole.
- **DVA.7-SST**: AISI 304 stainless steel boss, threaded blind hole.

FEATURES AND APPLICATIONS

The vibration-damping elements have been designed to damp vibrations, shocks and noises produced by moving bodies or non-balanced vibrating masses of equipment and machines which can cause:

- malfunctioning and reduction of the machine lifespan and/or of the adjacent ones;
- damage to health;
- noise.

Load diagrams for each single code are available on request. See Technical data and guidelines for the choice (on page 728).

SPECIAL EXECUTIONS ON REQUEST

Natural rubber NR, hardness 40, 70 tolerance ±5 Shore A for executions with AISI 304 stainless steel base.



DVA.6
DVA.6-SST

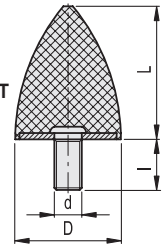

* Complete the description with the desired hardness: 40, 55 or 70 tolerance ±5 Shore A.

DVA.6 - 20 - 24 - M6 - 18 - 55
 D L d I Shore A

Description	D	L	d	I	⚖️	Hardness 40 Shore A			Hardness 55 Shore A			Hardness 70 Shore A					
						Code	Max load [N]	Max deflection [mm]	Stiffness [N/mm]	Code	Max load [N]	Max deflection [mm]	Stiffness [N/mm]	Code	Max load [N]	Max deflection [mm]	Stiffness [N/mm]
DVA.6-10-10-M5-12-*	10	10	M5	12	2	416991	46	3	14	413381	59	3	20	418791	113	3	40
DVA.6-20-15-M6-18-*	20	15	M6	18	9	416997	84	5	17	413397	194	4	48	418797	321	4	78
DVA.6-20-24-M6-18-*	20	24	M6	18	10	416101	82	6	14	413401	130	6	22	418801	330	6	55
DVA.6-25-20-M6-18-*	25	20	M6	18	15	416107	84	5	17	413407	190	5	38	418807	495	5	96
DVA.6-30-30-M8-18-*	30	30	M8	18	24	416111	190	8	25	413411	260	8	35	418811	630	8	84
DVA.6-30-36-M8-20-*	30	36	M8	20	39	416121	180	9	20	413421	320	9	36	418821	650	9	72
DVA.6-35-40-M8-23-*	35	40	M8	23	45	416131	260	10	26	413431	300	10	30	418831	630	10	63
DVA.6-50-50-M10-28-*	50	50	M10	28	110	416137	481	13	38	413437	740	13	59	418837	1656	13	132
DVA.6-50-61-M8-28-*	50	61	M8	28	114	416141	490	15	32	413441	600	15	39	418841	1520	15	100
DVA.6-50-68-M10-28-*	50	68	M10	28	131	416151	490	17	29	413451	890	17	52	418851	1950	17	115
DVA.6-70-58-M12-37-*	70	58	M12	37	258	416171	769	15	53	413471	1332	15	92	418871	1923	15	133
DVA.6-75-89-M12-37-*	75	89	M12	37	373	416181	971	22	44	413481	1680	22	76	418881	2328	22	105

Description	D	L	d	I	⚖️	Hardness 40 Shore A			Hardness 55 Shore A			Hardness 70 Shore A					
						Code	Max load [N]	Max deflection [mm]	Stiffness [N/mm]	Code	Max load [N]	Max deflection [mm]	Stiffness [N/mm]	Code	Max load [N]	Max deflection [mm]	Stiffness [N/mm]
DVA.6-10-10-SST-M5-12-55	10	10	M5	12	2	ON REQUEST	46	3	14	410499	59	3	20	ON REQUEST	113	3	40
DVA.6-20-15-SST-M6-18-55	20	15	M6	18	9	ON REQUEST	84	5	17	410500	194	4	48	ON REQUEST	321	4	78
DVA.6-20-24-SST-M6-18-55	20	24	M6	18	10	ON REQUEST	82	6	14	410501	130	6	22	ON REQUEST	330	6	55
DVA.6-25-20-SST-M6-18-55	25	20	M6	18	15	ON REQUEST	84	5	17	410503	190	5	38	ON REQUEST	495	5	96
DVA.6-30-30-SST-M8-18-55	30	30	M8	18	24	ON REQUEST	190	8	25	410505	260	8	35	ON REQUEST	630	8	84
DVA.6-30-36-SST-M8-20-55	30	36	M8	20	39	ON REQUEST	180	9	20	410507	320	9	36	ON REQUEST	650	9	72
DVA.6-35-40-SST-M8-23-55	35	40	M8	23	45	ON REQUEST	260	10	26	410511	300	10	30	ON REQUEST	630	10	63
DVA.6-50-50-SST-M10-28-55	50	50	M10	28	110	ON REQUEST	481	13	38	410519	740	13	59	ON REQUEST	1656	13	132
DVA.6-50-61-SST-M8-28-55	50	61	M8	28	114	ON REQUEST	490	15	32	410521	600	15	39	ON REQUEST	1520	15	100
DVA.6-50-68-SST-M10-28-55	50	68	M10	28	131	ON REQUEST	490	17	29	410523	890	17	52	ON REQUEST	1950	17	115
DVA.6-70-58-SST-M12-37-55	70	58	M12	37	258	ON REQUEST	769	15	53	410551	1332	15	92	ON REQUEST	1923	15	133
DVA.6-75-89-SST-M12-37-55	75	89	M12	37	373	ON REQUEST	971	22	44	410561	1680	22	76	ON REQUEST	2328	22	105



Machine elements