

- 1
- 2
- 3
- 4
- 5
- 6
- 7
- 8
- 9
- 10
- 11
- 12
- 13
- 14
- 15
- RH
-

BASE

Zinc-plated steel.

DAMPING ELEMENT

NR rubber, hardness 80 Shore A, black colour, matte finish.

LEVELLING PLATE

Zinc-plated steel.

PACKING RING

NBR synthetic rubber O-Ring.

THREADED STEM

Zinc-plated steel, supplied not assembled.

NUT AND WASHER

Zinc-plated steel.

FEATURES

ELESA vibration-damping levelling elements have been designed to damp vibrations, shocks and noises produced by moving bodies or non-balanced vibrating masses of equipment and machines which can cause:

- malfunctioning and reduction of the machine lifespan and/or of the adjacent ones;
- damage to operator's health;
- noise.

ASSEMBLY INSTRUCTIONS

- Put the base of the vibration-damping element under the machine and insert the stem through the hole (not threaded) in the frame of the machine (fig.1)
- Turn the square end of the stem to take the levelling plate in contact with the machine thus obtaining the levelling required. Then lock with nut and washer (fig.2)

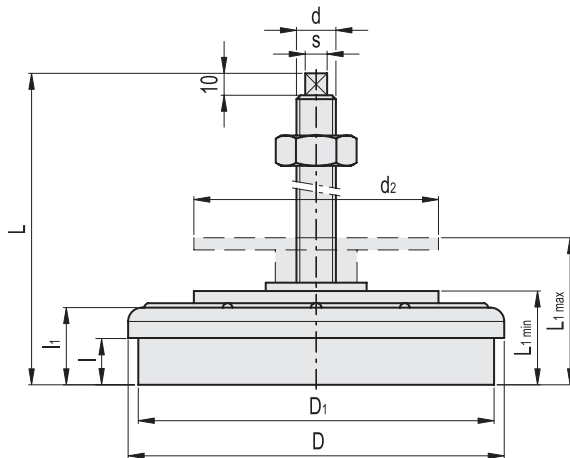
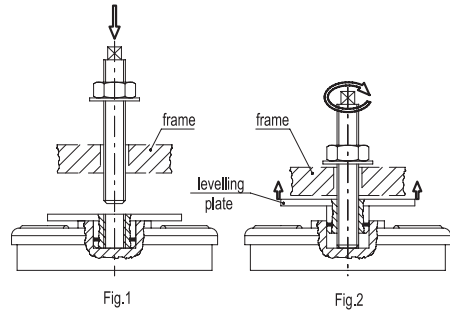

Code	Description	D	d	D1	L	L1 min+max	l	l1	d2	s	Max. limit static load [N]	Stiffness [N/mm]	Max. deflection [mm]	
415111	LW.A-80-M12x1.25x120	80	M12x1.25	72	133	35+46	18.5	32	60	7x7	5000	2500	2	530
415121	LW.A-120-M16x1.5x130	120	M16x1.5	109	144	40+51	23	36.5	80	9x9	10000	4000	2.5	1200
415131	LW.A-160-M20x1.5x170	160	M20x1.5	150	188	50+63	29	43.5	130	12x12	20000	9000	2.2	2650
415141	LW.A-200-M20x1.5x170	200	M20x1.5	186	198	60+73	36	54.5	130	12x12	40000	15000	2.7	4500