

Grub screw with hexagon socket and pointed end DIN EN ISO 4027

Item description/product images



Description

Material:

Steel or stainless steel A2.

Version:

Steel class 45 H, black.

Stainless steel A2-70, bright.

Note:

By M4x5, M5x5, M5x6, M6x6, M8x8, M10x10 the point angle is 120°.

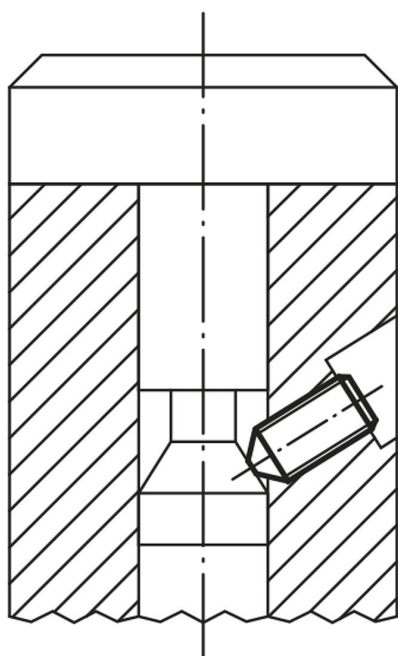

Drawings

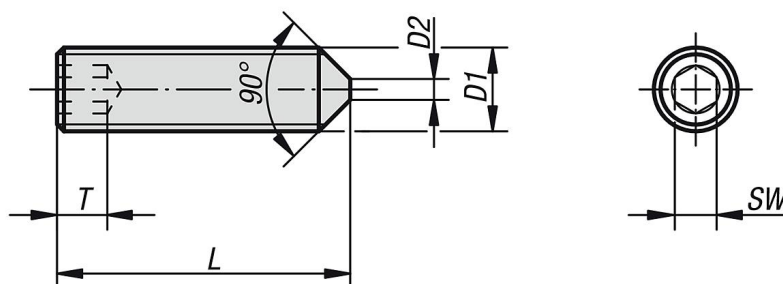

Overview of items

Grub screw with hexagon socket and pointed end, DIN EN ISO 4027