

## Hexagon head bolts DIN 933/ISO 4017, steel

### Item description/product images



### Description

**Material:**  
Steel.

**Version:**  
Steel grade 8.8, bright (black) or electro zinc-plated.  
Steel grade 10.9, bright (black) or electro zinc-plated.  
Steel grade 12.9, bright (black).

### Drawings

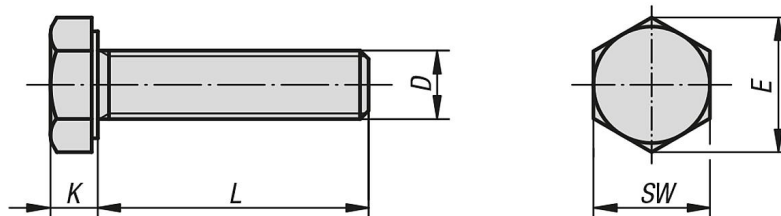

### Overview of items

Order No.	Material	Grade	Surface finish body	D	L	SW	E	K
K0871.04X10	steel	8.8	bright (black)	M4	10	7	7,66	2,8
K0871.04X12	steel	8.8	bright (black)	M4	12	7	7,66	2,8
K0871.04X16	steel	8.8	bright (black)	M4	16	7	7,66	2,8
K0871.04X18	steel	8.8	bright (black)	M4	18	7	7,66	2,8
K0871.04X20	steel	8.8	bright (black)	M4	20	7	7,66	2,8
K0871.04X25	steel	8.8	bright (black)	M4	25	7	7,66	2,8
K0871.05X10	steel	8.8	bright (black)	M5	10	8	8,79	3,5
K0871.05X12	steel	8.8	bright (black)	M5	12	8	8,79	3,5
K0871.05X16	steel	8.8	bright (black)	M5	16	8	8,79	3,5
K0871.05X18	steel	8.8	bright (black)	M5	18	8	8,79	3,5
K0871.05X20	steel	8.8	bright (black)	M5	20	8	8,79	3,5
K0871.05X25	steel	8.8	bright (black)	M5	25	8	8,79	3,5
K0871.05X30	steel	8.8	bright (black)	M5	30	8	8,79	3,5
K0871.05X35	steel	8.8	bright (black)	M5	35	8	8,79	3,5
K0871.05X40	steel	8.8	bright (black)	M5	40	8	8,79	3,5
K0871.06X10	steel	8.8	bright (black)	M6	10	10	11,05	4
K0871.06X12	steel	8.8	bright (black)	M6	12	10	11,05	4
K0871.06X16	steel	8.8	bright (black)	M6	16	10	11,05	4
K0871.06X18	steel	8.8	bright (black)	M6	18	10	11,05	4
K0871.06X20	steel	8.8	bright (black)	M6	20	10	11,05	4
K0871.06X25	steel	8.8	bright (black)	M6	25	10	11,05	4
K0871.06X30	steel	8.8	bright (black)	M6	30	10	11,05	4
K0871.06X35	steel	8.8	bright (black)	M6	35	10	11,05	4
K0871.06X40	steel	8.8	bright (black)	M6	40	10	11,05	4
K0871.06X45	steel	8.8	bright (black)	M6	45	10	11,05	4
K0871.06X50	steel	8.8	bright (black)	M6	50	10	11,05	4
K0871.06X55	steel	8.8	bright (black)	M6	55	10	11,05	4
K0871.06X60	steel	8.8	bright (black)	M6	60	10	11,05	4
K0871.08X16	steel	8.8	bright (black)	M8	16	13	14,38	5,3