

Shim washers DIN 988

Item description/product images

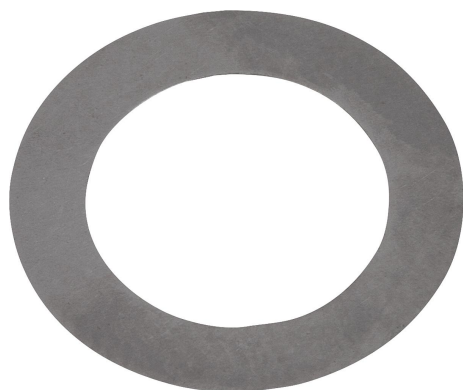

Description

Material:

Steel.

Version:

Bright.

Note:

With shim washers, an existing axial backlash can be significantly reduced. They are available with a thicknesses from 0.1 mm. Any thicknesses can be made by combining several shim washers.

Drawings

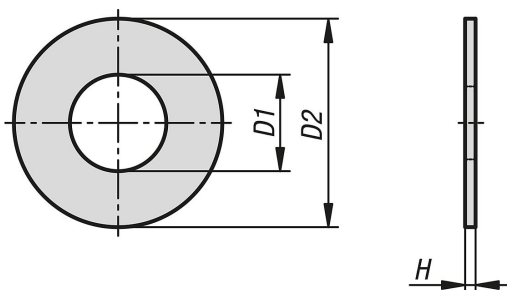

Overview of items

Shim washers DIN 988

| Order No. | Main material | D1 | D2 | H |
|---------------|---------------|----|----|------|
| K1151.0306010 | steel | 3 | 6 | 0,1 |
| K1151.0306015 | steel | 3 | 6 | 0,15 |
| K1151.0306020 | steel | 3 | 6 | 0,2 |
| K1151.0306025 | steel | 3 | 6 | 0,25 |
| K1151.0306030 | steel | 3 | 6 | 0,3 |
| K1151.0306050 | steel | 3 | 6 | 0,5 |
| K1151.0306100 | steel | 3 | 6 | 1 |
| K1151.0408010 | steel | 4 | 8 | 0,1 |
| K1151.0408015 | steel | 4 | 8 | 0,15 |
| K1151.0408020 | steel | 4 | 8 | 0,2 |
| K1151.0408030 | steel | 4 | 8 | 0,3 |
| K1151.0408050 | steel | 4 | 8 | 0,5 |
| K1151.0408100 | steel | 4 | 8 | 1 |
| K1151.0510010 | steel | 5 | 10 | 0,1 |
| K1151.0510015 | steel | 5 | 10 | 0,15 |
| K1151.0510020 | steel | 5 | 10 | 0,2 |
| K1151.0510025 | steel | 5 | 10 | 0,25 |
| K1151.0510030 | steel | 5 | 10 | 0,3 |
| K1151.0510050 | steel | 5 | 10 | 0,5 |
| K1151.0510100 | steel | 5 | 10 | 1 |
| K1151.0612010 | steel | 6 | 12 | 0,1 |
| K1151.0612020 | steel | 6 | 12 | 0,2 |
| K1151.0612025 | steel | 6 | 12 | 0,25 |
| K1151.0612030 | steel | 6 | 12 | 0,3 |
| K1151.0612050 | steel | 6 | 12 | 0,5 |
| K1151.0612100 | steel | 6 | 12 | 1 |