

## Socket head screws with low head DIN 6912, steel

### Item description/product images



### Description

#### Material:

Steel.

#### Version:

Steel grade 8.8, bright (black) or electro zinc-plated.

Steel grade 10.9, bright (black) or electro zinc-plated.

#### Note:

Screws where the dimension L is < B are threaded up to the head. The screw length or thread length is specified by the dimension L. Screws where L is > B have a shaft.

#### Drawing reference:

\* reference dimension

### Drawings

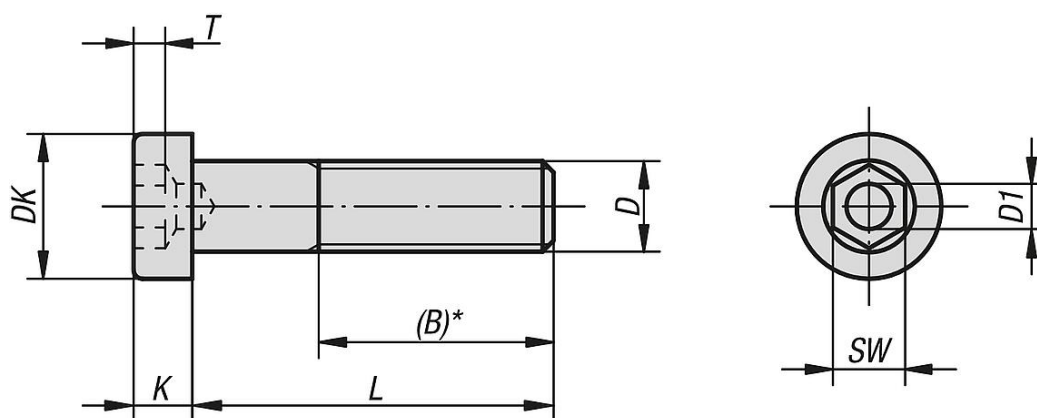

### Overview of items

Order No.	Main material	Grade	Surface finish body	D	L	B	DK	K	D1	SW	T
K1160.04X10	steel	8.8	bright (black)	M4	10	-	7	2,8	2	3	1,48
K1160.04X12	steel	8.8	bright (black)	M4	12	-	7	2,8	2	3	1,48
K1160.04X16	steel	8.8	bright (black)	M4	16	-	7	2,8	2	3	1,48
K1160.04X20	steel	8.8	bright (black)	M4	20	-	7	2,8	2	3	1,48
K1160.04X25	steel	8.8	bright (black)	M4	25	-	7	2,8	2	3	1,48
K1160.05X10	steel	8.8	bright (black)	M5	10	-	8,5	3,5	2,5	4	1,88
K1160.05X12	steel	8.8	bright (black)	M5	12	-	8,5	3,5	2,5	4	1,88
K1160.05X16	steel	8.8	bright (black)	M5	16	-	8,5	3,5	2,5	4	1,88
K1160.05X20	steel	8.8	bright (black)	M5	20	-	8,5	3,5	2,5	4	1,88
K1160.05X25	steel	8.8	bright (black)	M5	25	-	8,5	3,5	2,5	4	1,88
K1160.05X30	steel	8.8	bright (black)	M5	30	-	8,5	3,5	2,5	4	1,88