

Seating Pins • adjustable

EH 22690.



Product Description

The adjustable seating pins with induction hardened bearing surface can be used as seats and stops.

Material

Seating Pins

- Heat-treated steel, tempered, quality 10.9, blackened / bearing surface induction hardened

Nut

- Heat-treated steel, tempered, quality 8.8 (ISO 4035), blackened

Drawing

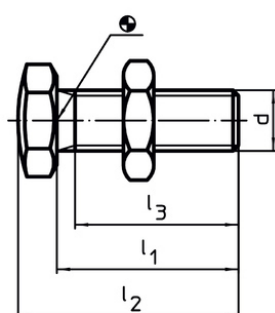

picture 1

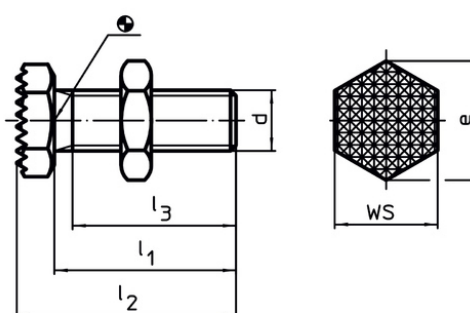

picture 2

Order information

Dimensions					WS		Art. No.
d	l ₁ ±1.5	l ₂ ±1.5	l ₃ min.	e			
[mm]					[mm]	[g]	
bearing surface spherical – picture 1							
M 6	20	23.5	19.0	11.5	10	6.7	22690.0606
M 8	25	30.0	21.0	14.5	13	15.0	22690.0608
M10	30	36.0	25.5	19.6	17	31.0	22690.0610
M12	35	42.0	29.7	21.9	19	48.0	22690.0612
M16	40	49.5	34.0	27.7	24	102.0	22690.0616
M20	45	57.0	37.0	34.6	30	187.0	22690.0620
M24	50	64.0	40.0	41.6	36	309.0	22690.0624
bearing surface ribbed – picture 2							
M 6	20	23.5	19.0	11.5	10	6.7	22690.0626
M 8	25	30.0	21.0	14.5	13	16.0	22690.0628
M10	30	36.0	25.5	19.6	17	31.0	22690.0630
M12	35	42.0	29.7	21.9	19	49.0	22690.0632
M16	40	49.5	34.0	27.7	24	102.0	22690.0636
M20	45	57.0	37.0	34.6	30	184.0	22690.0640
M24	50	64.0	40.0	41.6	36	308.0	22690.0644