

Pins · with plastic bearing surface

EH 22691.



Product Description

Pins with plastic bearing surface can be used as protective supports, stops, and thrust pads. This protects high-quality surfaces from damage.

Material

Insert

- Plastic (PEEK), blue

Threaded bushing

- stainless steel

Grub Screw

- stainless steel

Body

- Plastic (PEEK), blue
- Stainless steel 1.4305

Drawing

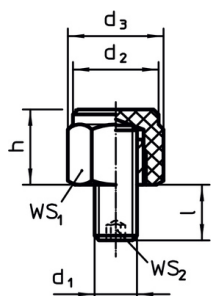

picture 1

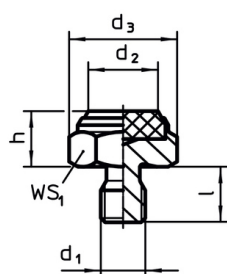

picture 2

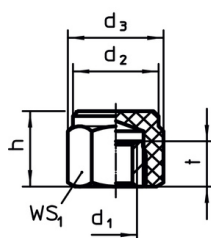

picture 3

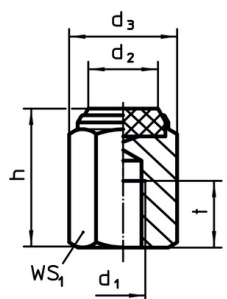

picture 4

Order information

h ±0.1	d ₁	Dimensions				WS ₁ [mm]	WS ₂ [mm]	Load capacity for static load max. [kN]	Tightening torque max. [Nm]	Temperature		Weight [g]	Art. No.	
		d ₂	d ₃	l	t					min.	max.			
[mm]														[°C]
with male thread, body made of plastic (PEEK), bearing surface plain – picture 1														
15	M 8	17.0	19.0	8 ± 1	–	17	4	8.5	10	-60	250	12.0	22691.0122	
20	M10	19.0	21.5	10 ± 1	–	19	5	9.5	10	-60	250	21.0	22691.0133	
20	M12	22.0	25.0	14 ± 1	–	22	6	14.0	10	-60	250	32.0	22691.0143	

¹⁾ The tightening torque of bolts with female thread is for threaded pins, quality 8. The bolt has to be tightened over the total thread length.