

## Thrust Screws • with plastic pad

### EH 22760.



#### Product Description

Thrust screws can be used for a gentle clamping or pressing of thread spindles, axes, shafts and surface treated parts.

#### Material

##### Pad

- Thermoplastic POM, white

##### Screw

- Steel, blackened
- Stainless steel 1.4305

#### More information

##### Further products

- Thrust Screws, with brass pad

#### Drawing

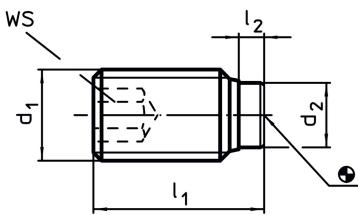

#### Order information

Dimensions				WS	min.  max.			Art. No.
d <sub>1</sub>	l <sub>1</sub>	l <sub>2</sub>	d <sub>2</sub>	[mm]	[°C]		[g]	
[mm]								
<b>stainless steel</b>								
M 3	3.8	0.8	1.5	1.5	-30	80	0.1	<a href="#">22760.0632</a>
M 3	5.8	0.8	1.5	1.5	-30	80	0.3	<a href="#">22760.0634</a>
M 3	8.8	0.8	1.5	1.5	-30	80	0.4	<a href="#">22760.0636</a>
M 3	10.8	0.8	1.5	1.5	-30	80	0.4	<a href="#">22760.0638</a>
M 4	7.0	1.0	2.0	1.5	-30	80	0.3	<a href="#">22760.0642</a>
M 4	9.0	1.0	2.0	2.0	-30	80	0.5	<a href="#">22760.0643</a>
M 4	11.0	1.0	2.0	2.0	-30	80	0.7	<a href="#">22760.0644</a>
M 4	13.0	1.0	2.0	2.0	-30	80	0.7	<a href="#">22760.0645</a>
M 4	17.0	1.0	2.0	2.0	-30	80	1.1	<a href="#">22760.0646</a>
M 5	9.0	1.0	3.0	2.5	-30	80	0.7	<a href="#">22760.0652</a>
M 5	11.0	1.0	3.0	2.5	-30	80	0.9	<a href="#">22760.0653</a>
M 5	13.0	1.0	3.0	2.5	-30	80	1.2	<a href="#">22760.0654</a>
M 5	17.0	1.0	3.0	2.5	-30	80	1.6	<a href="#">22760.0655</a>
M 5	21.0	1.0	3.0	2.5	-30	80	2.2	<a href="#">22760.0656</a>
M 6	11.3	1.3	3.5	3.0	-30	80	1.3	<a href="#">22760.0662</a>
M 6	13.3	1.3	3.5	3.0	-30	80	1.7	<a href="#">22760.0663</a>
M 6	17.3	1.3	3.5	3.0	-30	80	2.2	<a href="#">22760.0664</a>
M 6	21.3	1.3	3.5	3.0	-30	80	3.0	<a href="#">22760.0665</a>
M 6	26.3	1.3	3.5	3.0	-30	80	3.8	<a href="#">22760.0666</a>
M 6	33.3	1.3	3.5	3.0	-30	80	5.1	<a href="#">22760.0667</a>
M 8	13.6	1.6	5.0	4.0	-30	80	2.5	<a href="#">22760.0682</a>
M 8	17.6	1.6	5.0	4.0	-30	80	3.7	<a href="#">22760.0683</a>
M 8	21.6	1.6	5.0	4.0	-30	80	5.0	<a href="#">22760.0684</a>
M 8	26.6	1.6	5.0	4.0	-30	80	6.5	<a href="#">22760.0685</a>
M 8	33.6	1.6	5.0	4.0	-30	80	8.8	<a href="#">22760.0686</a>
M 8	41.6	1.6	5.0	4.0	-30	80	11.0	<a href="#">22760.0687</a>
M10	17.9	1.9	6.5	5.0	-30	80	5.4	<a href="#">22760.0702</a>
M10	21.9	1.9	6.5	5.0	-30	80	7.2	<a href="#">22760.0703</a>
M10	26.9	1.9	6.5	5.0	-30	80	9.9	<a href="#">22760.0704</a>