

## Shaft / Plain Washers • DIN 6340 heat-treated EH 23060.

### Product Description

The heat-treated shaft / plain washers (washers) are manufactured according to DIN 6340.



### Material

- Heat-treated steel, tempered, punched, mechanically trued, phosphatized

### Drawing

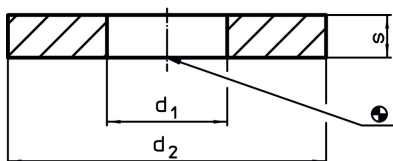

### Order information

d <sub>1</sub>	Dimensions		s	For screws		Art. No.
	d <sub>2</sub>	[mm]		[mm]	[g]	
6.4	17		3	M 6	3.8	<a href="#">23060.0006</a>
8.4	23		4	M 8	9.8	<a href="#">23060.0008</a>
10.5	28		4	M10	15.0	<a href="#">23060.0010</a>
13.0	35		5	M12	28.0	<a href="#">23060.0012</a>
15.0	40		5	M14	40.0	<a href="#">23060.0014<sup>1)</sup></a>
17.0	45		6	M16	55.0	<a href="#">23060.0016</a>
19.0	45		6	M18	53.0	<a href="#">23060.0018<sup>1)</sup></a>
21.0	50		6	M20	65.0	<a href="#">23060.0020</a>
23.0	50		8	M22	86.0	<a href="#">23060.0022<sup>1)</sup></a>
25.0	60		8	M24	122.0	<a href="#">23060.0024</a>
31.0	68		10	M30	199.0	<a href="#">23060.0030</a>
38.0	80		12	M36	360.0	<a href="#">23060.0036<sup>1)</sup></a>

<sup>1)</sup> DIN standards do not include these dimensions.