

## Drive Blocks • DIN 2079

EH 23100.

### Product Description

These drive blocks are manufactured according to DIN 2079.



### Material

- Alloyed case-hardened steel, case-hardened, blackened, ground

### Drawing

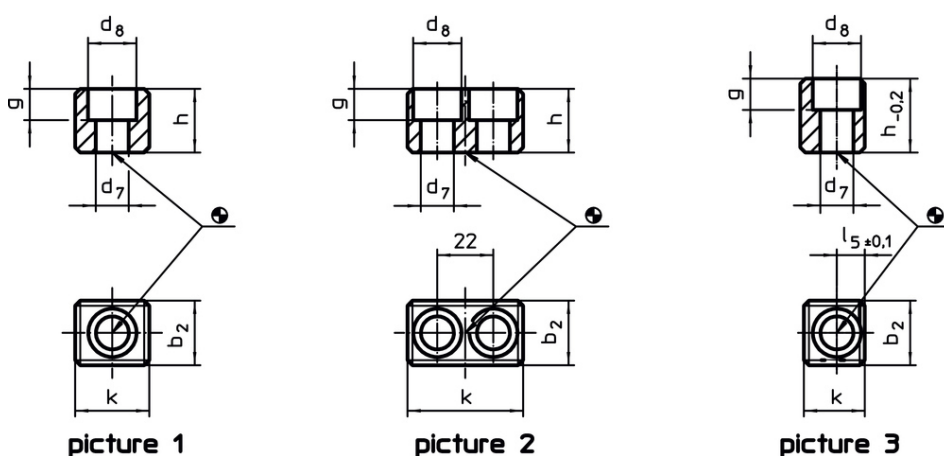

### Order information

Spindle head No.	Dimensions							For screws ISO 4762	[g]	Art. No.
	k	b <sub>2</sub> h5	d <sub>7</sub>	d <sub>8</sub>	g	h	l <sub>5</sub> ±0.1			
[mm]										
<b>for spindle heads no. 30 to 60, form A – picture 1</b>										
30	16.5	15.9	6.4	10.4	6.2	16.0	–	M 6 x 16	26	<a href="#">23100.0030</a>
40	19.5	15.9	6.4	10.4	6.2	16.0	–	M 6 x 16	32	<a href="#">23100.0040</a>
45	19.5	19.0	8.4	13.5	8.3	19.0	–	M 8 x 20	40	<a href="#">23100.0045</a>
50 – 55	26.5	25.4	13.0	19.0	12.3	25.0	–	M12 x 25	88	<a href="#">23100.0050</a>
60	45.5	25.4	13.0	19.0	12.3	25.0	–	M12 x 25	181	<a href="#">23100.0060</a>
<b>for spindle heads no. 60 form B – picture 2</b>										
60	45.5	25.4	13.0	19.0	12.3	25.0	–	M12 x 25	140	<a href="#">23100.0160</a>
<b>for spindle heads no. 30 to 50, form C – picture 3</b>										
30	13.5	15.9	6.4	10.4	6.2	24.5	5.5	M 6 x 25	32	<a href="#">23100.0230</a>
40	16.5	15.9	6.4	10.4	6.2	24.5	7.0	M 6 x 25	40	<a href="#">23100.0240</a>
45	17.5	19.0	8.4	13.5	10.0	26.0	7.5	M 8 x 25	48	<a href="#">23100.0245</a>
50	24.0	25.4	13.0	19.0	12.3	29.0	11.0	M12 x 30	90	<a href="#">23100.0250</a>