

Adjustable Clamping Levers • with axial bearing from stainless steel, with screw EH 24420.



Product Description

Adjustable clamping levers with rust-proof inner parts. Suitable for multiple applications, e.g. medical environments, chemical industry, and so on.

Advantages of axial bearing:

- Double clamping force with same lever size, by reducing the surface friction.
- Protection of workpiece by a fixed locating surface.
- Little setting due to higher pre-clamping force of bolt, e.g. thread.

Material

Lever

- Zinc die-cast, plastic coated, orange similar to RAL 2004, matt structure
- Zinc die-cast, plastic coated, black, similar to RAL 9005, matt structure

Inner parts

- stainless steel

Screw

- stainless steel

Operation

By lifting the lever the serrations are disengaged. The lever can be positioned by the serrations. On releasing the lever, the serrations are automatically re-engaged.

Drawing

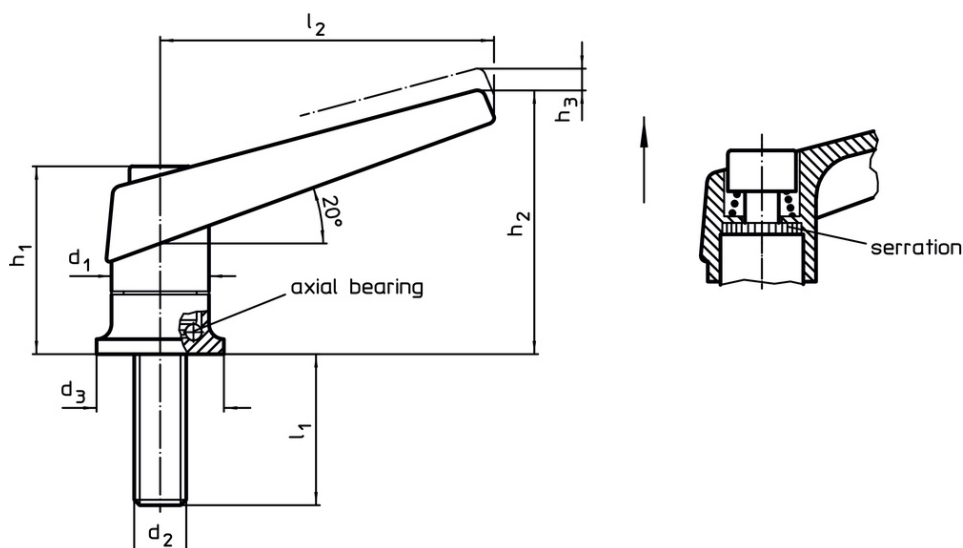

Order information

Dimensions									Art. No.
d ₁	d ₂	l ₁	d ₃	h ₁	h ₂	h ₃	l ₂		
[mm]								[g]	
orange									
18	M 6	20	24	34.5	50	3.0	62	96	24420.1030
18	M 6	27	24	34.5	50	3.0	62	99	24420.1050
22	M 8	21	25	39.5	56	3.5	74	148	24420.1130
22	M 8	36	25	39.5	56	3.5	74	152	24420.1150
25	M10	29	30	46.5	66	4.0	89	227	24420.1230
25	M10	47	30	46.5	66	4.0	89	239	24420.1250
30	M12	34	35	56.5	82	5.0	108	404	24420.1330
30	M12	50	35	56.5	82	5.0	108	419	24420.1346
30	M12	57	35	56.5	82	5.0	108	420	24420.1350
30	M12	65	35	56.5	82	5.0	108	430	24420.1364
30	M12	85	35	56.5	82	5.0	108	444	24420.1384