

## Spoked Handwheels • light metal

EH 24610.

### Product Description

For all handwheels, the hub is machined, rim is turned and mirror-finished on all sides. The unmachined raw surfaces have been blasted clean. Together with their mirror-polished rim, these handwheels therefore present a finish which generally does not require additional lacquering.



#### Material

##### Axle part

- Steel, zinc-plated by galvanization

##### Handwheel

- Aluminium permanent-mould casting

##### Cylindrical handle EH 24530

- DIN 7708 - thermosetting plastic (PF 31), black similar to RAL 9005

#### Assembly

Shaft-end washers EH 22270. for axial fastening.

#### More information

#### Further products

- Shaft-End Washers
- Cylindrical Handles, rotating

### Drawing

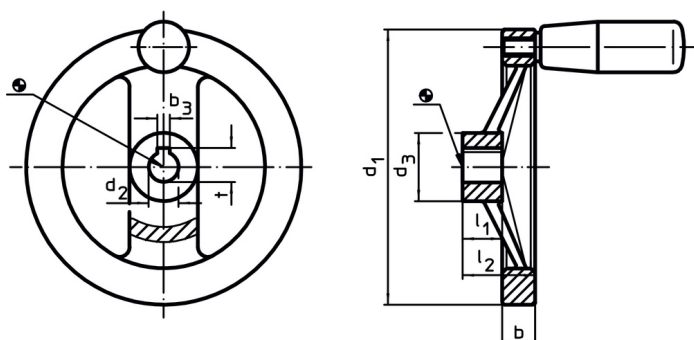

The orientation of the hub keyway may be different than shown in the drawing.

### Order information

Dimensions						Hub keyway, DIN 6885 sheet 1		Corresponding cylindrical handle EH 24530.	max.		Art. No.
d <sub>1</sub>	d <sub>2</sub> H7	d <sub>3</sub>	b	l <sub>1</sub>	l <sub>2</sub> ~	b <sub>3</sub>	t	[mm]	[°C]	[g]	
[mm]						[mm]		[mm]			
<b>without hub keyway, without cylindrical handle</b>											
125	12	31	15.0	18	33	–	–	–	–	301	24610.0010
125	14	31	15.0	18	33	–	–	–	–	300	24610.0011
140	14	36	16.5	19	36	–	–	–	–	400	24610.0015
140	16	36	16.5	19	36	–	–	–	–	396	24610.0016
160	14	36	18.0	20	39	–	–	–	–	520	24610.0020
160	16	36	18.0	20	39	–	–	–	–	526	24610.0021
200	18	42	20.5	24	45	–	–	–	–	886	24610.0030
200	20	42	20.5	24	45	–	–	–	–	876	24610.0031
250	22	48	23.0	28	51	–	–	–	–	1454	24610.0040
250	26	48	23.0	28	51	–	–	–	–	1516	24610.0041
<b>with hub keyway, without cylindrical handle</b>											
125	12	31	15.0	18	33	4	13.8	–	–	303	24610.0110
125	14	31	15.0	18	33	5	16.3	–	–	306	24610.0111
140	14	36	16.5	19	36	5	16.3	–	–	406	24610.0115
140	16	36	16.5	19	36	5	18.3	–	–	404	24610.0116
160	14	36	18.0	20	39	5	16.3	–	–	542	24610.0120
160	16	36	18.0	20	39	5	18.3	–	–	525	24610.0121
200	18	42	20.5	24	45	6	20.8	–	–	887	24610.0130
200	20	42	20.5	24	45	6	22.8	–	–	875	24610.0131
250	22	48	23.0	28	51	6	24.8	–	–	1446	24610.0140
250	26	48	23.0	28	51	8	29.3	–	–	1443	24610.0141