

## Torque Handles

EH 24710.



### Product Description

Torque handles are used wherever a limitation of the exerted hand force is required. The handle, similar to a knurled nut / knurled thumb screw, with integrated torque mechanism allows a defined torque limit during tightening. Reaching the torque results in an "over-locking". For releasing the torque is transmitted indefinitely. These handles combine the functionality of a ratchet wrench with the modern and ergonomic design of a knurled nut / knurled thumb screw.

### Material

#### Cap

- Thermoplastic PA 6, light grey, similar to RAL 7035

#### Torque mechanism

- Steel, hardened

#### Handle

- Aluminium, black anodised

#### Inner part

- Steel, blackened

#### Screw

- Steel, blackened

### More information

#### Further products

- Three-Lobed Torque Handles

### Drawing

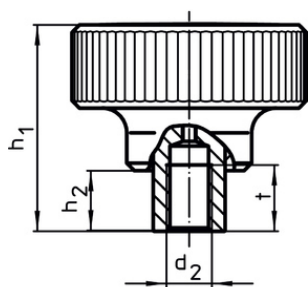

picture 1

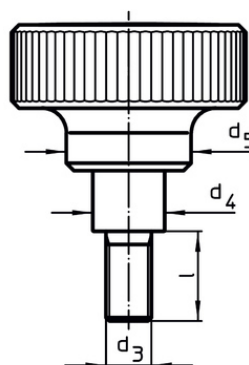
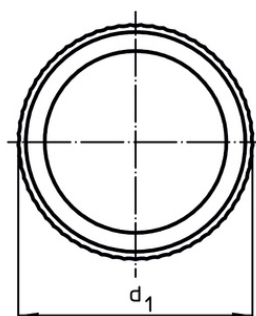

picture 2

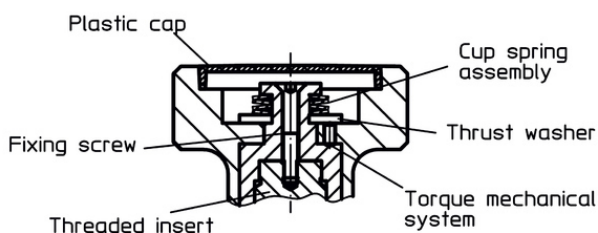

### Order information

Dimensions									max. [°C]	Tightening torque +/- 10% max. [Nm]	[g]	Art. No.
d <sub>1</sub>	d <sub>2</sub>	d <sub>3</sub>	l	d <sub>4</sub>	d <sub>5</sub>	h <sub>1</sub>	h <sub>2</sub>	t				
with female thread – picture 1												
34	M 3	–	–	10.0	21	37.5	9.5	7	100	1.0	48	24710.0020
34	M 4	–	–	10.0	21	37.5	9.5	9	100	1.0	60	24710.0022
34	M 5	–	–	10.0	21	37.5	9.5	9	100	1.0	62	24710.0024
34	M 6	–	–	10.0	21	37.5	9.5	9	100	1.0	60	24710.0026
42	M 6	–	–	13.5	27	43.5	11.5	11	100	2.0	111	24710.0030
42	M 8	–	–	13.5	27	43.5	11.5	11	100	2.0	112	24710.0032