

DAMPER HINGE HG-JHM14

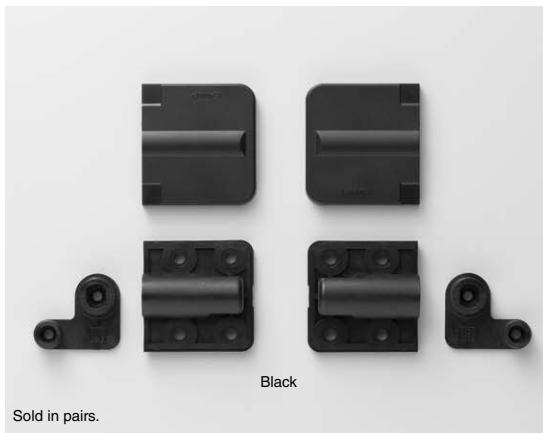

INSTRUCTION

TORQUE
HINGESDAMPER
HINGESLIFT
ASSIST
HINGESDETENT
HINGESCONCEALED
HINGESBUTT
HINGESPIANO
HINGESSTEP
HINGESLIFT-
OFF
HINGESPIVOT
HINGESSPRING
HINGESCLEAN
ROOM
HINGESHINGES FOR
ALUMINIUM
FRAMEDROP
HINGESGLASS
DOOR
HINGESSPECIAL
HINGES

- Hinge with built-in damper UDH-14 1.
- Smooth movement in the opening direction.
- Cover hides mounting screws for clean appearance.
- Easy to cut out with a router.

[Specification]

- Operating temperature: 0°C~40°C

[Remarks]

- Be sure to read the "Cautions" 2.
- The installation example in the Manual Instruction is for wooden lid.
- Sold in pairs.
- When installing, ensure that both hinge shafts are levelled and aligned.
- Damper mechanism works when opening the lid by about 60° or more.

[Sold Separately]

- Bracket for under mount (UKZ14) also available 3.

Selection Tool



Sasuga-kun

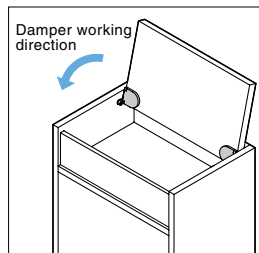

Side Mount Type

[Top View]

[Installation]

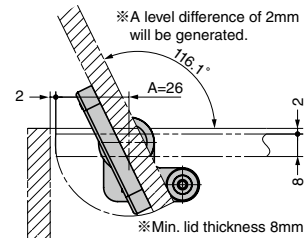
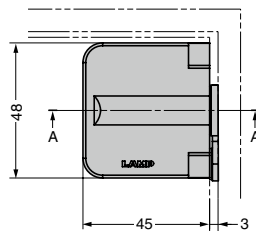
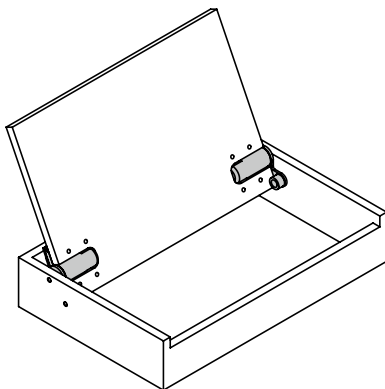





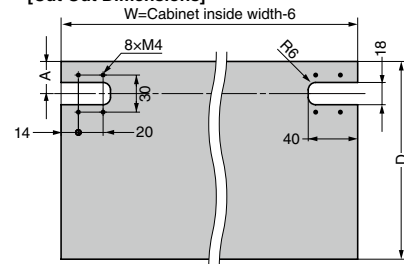
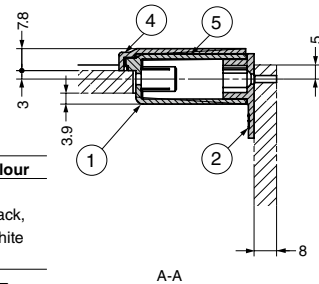







[Cross-section Drawing]

[Cut Out Dimensions]



No.	Part Name	Material	Colour
①	Body	POM	Black, White
②	Bracket for side mount R	Reinforced	
③	Bracket for side mount L	PBT	
④	Cover	ABS	—
⑤	Damper	—	

RoHS	CAD	Item Code	Item Name	Colour	Torque N·m/pair	Torque kgf·cm/pair	Marking Colour	Opening Angle	Weight (g)	Box (pairs)	Carton (pairs)
		170-031-930	HG-JHM14-S-8BL	Black	0.5~0.8	5.1~8.2	Purple	105°	51.4	20	220
		170-031-931	HG-JHM14-S-8WT	White					51.4	20	220
		170-031-932	HG-JHM14-S-15BL	Black	0.8~1.5	8.2~15.3	Blue		51.4	20	220
		170-031-933	HG-JHM14-S-15WT	White					51.4	20	220
		170-031-934	HG-JHM14-S-20BL	Black	1.5~2	15.3~20.4	Green		51.4	20	220
		170-031-935	HG-JHM14-S-20WT	White					51.4	20	220

Refer to 1 : P.117, 2 : P.43, 3 : P.103