

MAGNETIC CATCH MC-YS



- Thin magnetic catch of 6mm high ideal for tight spaces.
- Small body with strong magnetic force by using neodymium magnet: MC-YS001, MC-YS001P.
- Weaker magnetic force (ferrite magnet): MC-YS002, MC-YS002P.
- Zinc alloy MC-YC-06 1 with strong magnetic force also available.

[Remarks]

- Be sure to read the "Cautions" 2 .
- Max. temperature for neodymium magnet: 80°C

[Parts Included]

For MC-YS001P, MC-YS002P only

- Counter Plate
- Countersunk head wood screw 2.9×13, pan head wood screw 3.1×13

| No. | Part Name | Material | | Finish / Colour | |
|-----|---------------|-----------------------|-----------------------|------------------------------------|---------------------------------|
| | | MC-YS001 MC-YS001P | MC-YS002 MC-YS002P | MC-YS001 MC-YS001P | MC-YS002 MC-YS002P |
| ① | Body | PBT | | White | |
| ② | Yoke | Steel (SPCC) | | Coloured Zinc Chromate (Trivalent) | Clear Zinc Chromate (Trivalent) |
| ③ | Magnet | Neodymium | Ferrite | Nickel | — |
| ④ | Counter Plate | Steel | | Coloured Zinc Chromate (Trivalent) | |

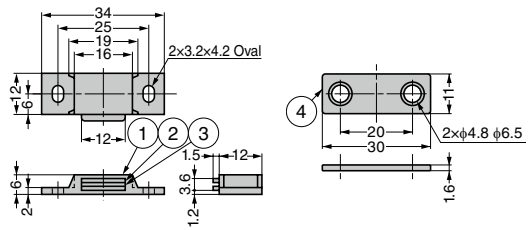

| RofS | CAD | Item Code | Item Name | Type | Magnetic Force N | Magnetic Force kgf | Weight (g) | Box (pcs) | Carton (pcs) |
|------|-----|-------------|-----------|---|------------------|--------------------|------------|-----------|--------------|
| ☑ | ☑ | 140-050-298 | MC-YS001 | Magnetic Catch Only | 29.4 | 3 | 6 | 100 | 1000 |
| ☑ | ☑ | 140-050-296 | MC-YS001P | Magnetic Catch · Counter Plate & Screws | | | | 100 | 1000 |
| ☑ | ☑ | 140-050-297 | MC-YS002 | Magnetic Catch Only | 12 | 1.2 | 5 | 100 | 1000 |
| ☑ | ☑ | 140-050-295 | MC-YS002P | Magnetic Catch · Counter Plate & Screws | | | | 100 | 500 |

Refer to 1 : P.436, 2 : P.431

MAGNETIC CATCH MC-YSW SNAP-IN TYPE

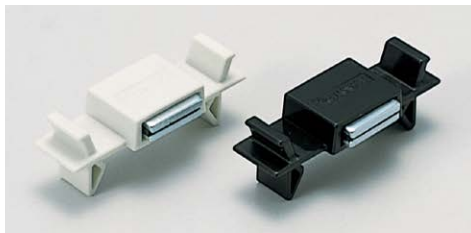

- Snap-in magnetic catch for sheet metal applications.
- Thin magnetic catch of 6mm high ideal for tight spaces.
- Small body with strong magnetic force by using neodymium magnet: MC-YSW02.

[Remarks]

- Be sure to read the "Cautions" 1 .
- Max. temperature for neodymium magnet: 80°C
- For 1mm and 2mm door, please use spacer YS-P05 (not need for 1.6mm and 2.6mm door).

[Sold Separately]

- Spacer YS-P05

[Cut Out Dimensions]

For 1mm door (Need YS-P05)

For 1.6mm door (No need YS-P05)

For 2mm door (Need YS-P05)

For 2.6mm door (No need YS-P05)

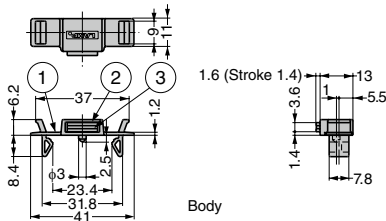

Body



Spacer YS-P05

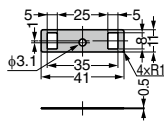

Spacer

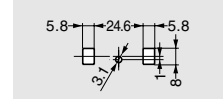
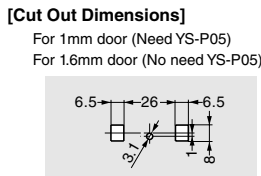

[Body]

| RofS | CAD | Item Code | Item Name | Colour | Magnet | Magnetic Force N | Magnetic Force kgf | Weight (g) | Box (pcs) | Carton (pcs) |
|------|-----|-------------|-----------|--------|-----------|------------------|--------------------|------------|-----------|--------------|
| ☑ | ☑ | 140-050-002 | MC-YSW02W | White | Neodymium | 29 | 3 | 5.5 | 100 | 1000 |
| ☑ | ☑ | 140-050-029 | MC-YSW02B | Black | | | | | 100 | 1000 |

[Spacer] Sold Separately

| RofS | CAD | Item Code | Item Name | Material | Colour | Weight (g) | Box (pcs) | Carton (pcs) |
|------|-----|-------------|-----------|----------|---------|------------|-----------|--------------|
| ☑ | ☑ | 140-050-003 | YS-P05 | PP | Natural | 0.16 | 1000 | 10000 |

Refer to 1 : P.431