

HANDLE MJH

TEST
METHOD 1

- Handle can be installed from both front and back. Cap hides screw heads for clean appearance (option). 3 colours available.
- Rounded inside allows for easy gripping.
- Caps are tightly fixed to prevent from falling off.
- Possible to customise cap colour from 3,000 pcs.
- MJH-150 is compliant with SEMI standard (SEMI S8-0308).

[Remarks]

- Only hexagon socket head screw is available for front mounting.
- Caps are sold separately. Sold by piece. Please order together with handle.

[Recommended Screws]

- MJH-93 : Hexagon socket head cap screw M6
- MJH-120, MJH-150 : Hexagon socket head cap screw M8

※Caps are sold separately.

[Caps] Option

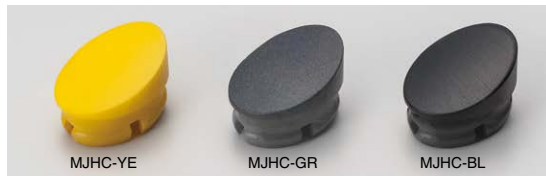

[Installation]

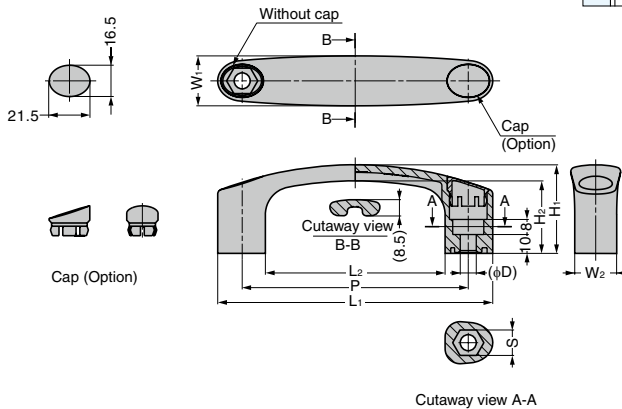
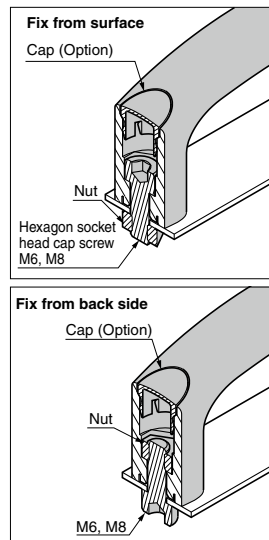
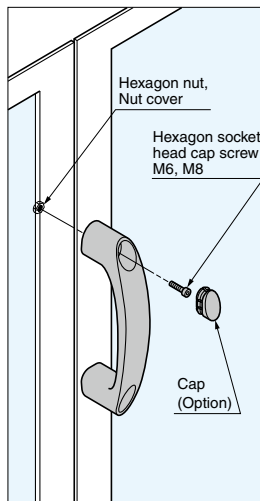

[Body]

RHS	CAD	Item Code	Item Name	Material	Colour	P	L ₁	L ₂	D	S	H ₁	H ₂	W ₁	W ₂	Load Capacity N	Load Capacity kgf	Weight (g)	Box (pcs)	Carton (pcs)
		100-026-534	MJH-93	Reinforced Nylon	Black	93	116.5	68.5	6.5	10.2	42	33.5	25	19.2	450	46	41	100	—
		100-026-535	MJH-120			120	143	96	8.5	13.2	47	38.5	26.5	19			48	50	—
		100-026-536	MJH-150			150	173	126			52	43.5	28	18.8			58	50	—

[Caps] Option (Sold by piece)

RHS	CAD	Item Code	Item Name	Material	Colour	Weight (g)	Box (pcs)	Carton (pcs)
		100-026-537	MJHC-BL	Reinforced Nylon	Black	1.4	100	—
		100-026-538	MJHC-GR		Grey		100	—
		100-026-539	MJHC-YE		Yellow		100	—