

STAINLESS STEEL HANDLE H-42-C

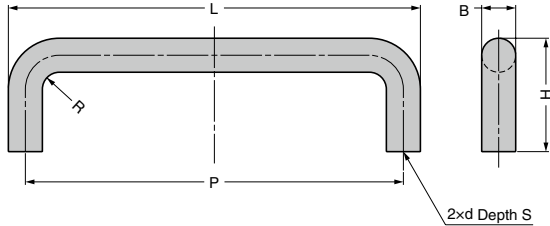

- Optional bracket H-42-Z **1** is available.
- AS parts set for installing to aluminium frame also available. Content of the parts set is as follows.
- Titanium handles **2** of the same size as H-42-C-2, H-42-C-4 and H-42-C-15 also available. (L and B dimensions are slightly different from H-42-C-2)



LARGE HANDLES

HANDLES (FRONT SCREW MOUNT)

HANDLES (BACK SCREW MOUNT)

RECESSED PULLS

PULLS & KNOBS

LATCH HANDLES

[Handle]

RoHS	CAD	Item Code	Item Name	Material	Finish	L	H	B	P	R	d	S	Weight (g)	Box (pcs)	Carton (pcs)
✓	3D	100-010-560	H-42-C-8	Stainless Steel (SUS304)	Polished	66	22	6	60	3	M4	7	18	100	500
✓	3D	100-010-562	H-42-C-14			86	80		25				50	250	
✓	3D	100-010-561	H-42-C-1			75	30	7	68	3.5	M5	8	30	50	250
✓	3D	100-010-563	H-42-C-2			109	9	100	4.5	65			50	150	
✓	3D	100-010-564	H-42-C-3			120	40	10	110	5	M6	8	100	50	150
✓	3D	100-010-565	H-42-C-4			130			120				105	50	150
✓	3D	100-010-566	H-42-C-15			162	50	12	150	6	M8	10	185	30	60
✓	3D	100-010-567	H-42-C-5			200			188				220	30	60
✓	3D	100-010-568	H-42-C-6			250			238				265	20	40
✓	3D	100-010-569	H-42-C-7			300			288				300	20	40

Refer to **1** : P.651, **2** : P.650

Parts Set for Installing to Aluminium Frame

Please refer to the series introduction page **1** for details about AS series.

[AS Parts Set] Parts set of brackets, screws and AS nuts used for installing to aluminium frame.

RoHS	CAD	Item Code	Item Name	Aluminium Frame	Parts	Weight (g)
✓	-	100-041-484	AS-H-42-C-1-8	Groove Width 8 mm	Handle H-42-C-1 : 1pc Bracket for Handle AS-H30 : 2pcs AS Nut AS-8M5 : 2pcs M5×10 Hexagon Socket Countersunk Head Screw : 4pcs	-
✓	-	100-041-485	AS-H-42-C-1-10	Groove Width 10 mm	Handle H-42-C-1 : 1pc Bracket for Handle AS-H30 : 2pcs AS Nut AS-10M5 : 2pcs M5×10 Hexagon Socket Countersunk Head Screw : 2pcs M5×12 Hexagon Socket Countersunk Head Screw : 2pcs	-
✓	-	100-041-486	AS-H-42-C-2-8	Groove Width 8 mm	Handle H-42-C-2 : 1pc Bracket for Handle AS-H30 : 2pcs AS Nut AS-8M5 : 2pcs M5×10 Hexagon Socket Countersunk Head Screw : 4pcs	-
✓	-	100-041-487	AS-H-42-C-2-10	Groove Width 10 mm	Handle H-42-C-2 : 1pc Bracket for Handle AS-H30 : 2pcs AS Nut AS-10M5 : 2pcs M5×10 Hexagon Socket Countersunk Head Screw : 2pcs M5×12 Hexagon Socket Countersunk Head Screw : 2pcs	-

[How to Install]

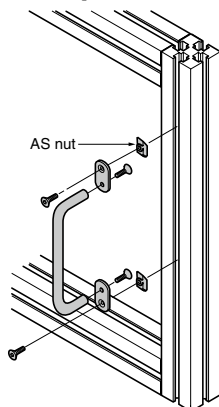
Refer to **1** : P.20, **2** : P.651, **3** : P.526