

GROMMET BW

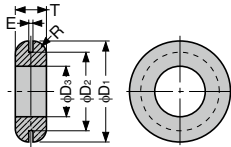

● Flam retardant material (UL94V-0) available by made to order.

| Material | Hardness | Colour |
|----------|----------|--------|
| EPDM | 50° ± 5° | Black |

| RHS | CAD | Item Code | Item Name | D ₁ | D ₂ | D ₃ | E | T | R | Weight (g) | Pack (pcs) | Box (packs) | Carton (pcs) | |
|-----|-----|-------------|--------------|----------------|----------------|----------------|---|----|-----|------------|------------|-------------|--------------|---|
| ✓ | 3D | 210-038-040 | BW-188-P100 | 18 | 12 | 6 | 1 | 7 | 3 | 2.5 | 100 | 1 | 5 | |
| ✓ | 3D | 210-038-041 | BW-189-P100 | | | | 2 | 8 | | | 100 | 1 | 5 | |
| ✓ | 3D | 210-038-042 | BW-208-P100 | 20 | 14 | 8 | 1 | 7 | | | 100 | 1 | 5 | |
| ✓ | 3D | 210-038-043 | BW-209-P100 | | | | 2 | 8 | | | 100 | 1 | 5 | |
| ✓ | 3D | 210-038-044 | BW-228-P100 | 22 | 16 | 10 | 1 | 10 | | | 100 | 1 | 5 | |
| ✓ | 3D | 210-038-045 | BW-229-P100 | | | | 2 | 9 | | | 100 | 1 | 5 | |
| ✓ | 3D | 210-038-046 | BW-2610-P100 | 26 | 19 | 12 | 1 | 10 | 4 | 5 | 100 | 1 | 5 | |
| ✓ | 3D | 210-038-047 | BW-2611-P100 | | | | 2 | 11 | | 100 | 1 | 5 | | |
| ✓ | 3D | 210-038-048 | BW-2910-P100 | 29 | 22 | 14 | 1 | 10 | | 6 | 100 | 1 | 5 | |
| ✓ | 3D | 210-038-049 | BW-2911-P100 | | | | 2 | 11 | | 100 | 1 | 5 | | |
| ✓ | 3D | 210-038-050 | BW-3210-P100 | 32 | 25 | 16 | 1 | 10 | | 7 | 100 | 1 | 5 | |
| ✓ | 3D | 210-038-051 | BW-3211-P100 | | | | 2 | 11 | | 100 | 1 | 5 | | |
| ✓ | 3D | 210-038-052 | BW-3512-P100 | 35 | 28 | 19 | 1 | 12 | 8 | 100 | 1 | 5 | | |
| ✓ | 3D | 210-038-053 | BW-3513-P100 | | | | 2 | 13 | 100 | 1 | 5 | | | |
| ✓ | 3D | 210-038-054 | BW-4012-P100 | 40 | 32 | 22 | 1 | 12 | 5 | 15 | 100 | 1 | 5 | |
| ✓ | 3D | 210-038-055 | BW-4013-P100 | | | | 2 | 13 | | 100 | 1 | 5 | | |
| ✓ | 3D | 210-038-056 | BW-4414-P50 | 44 | 36 | 25 | 1 | 14 | | 20 | 50 | 1 | 2 | |
| ✓ | 3D | 210-038-057 | BW-4415-P50 | | | | 2 | 15 | | 50 | 1 | 2 | | |
| ✓ | 3D | 210-038-058 | BW-4814-P50 | 48 | 40 | 28 | 1 | 14 | | 6 | 50 | 1 | 2 | |
| ✓ | 3D | 210-038-059 | BW-4815-P50 | | | | 2 | 15 | | | 50 | 1 | 2 | |
| ✓ | 3D | 210-038-060 | BW-5218-P50 | 52 | 44 | 32 | 1 | 18 | 8 | | 30 | 50 | 1 | 2 |
| ✓ | 3D | 210-038-061 | BW-5219-P50 | | | | 2 | 19 | | | 50 | 1 | 2 | |
| ✓ | 3D | 210-038-062 | BW-5618-P50 | 56 | 48 | 36 | 1 | 18 | | | 35 | 50 | 1 | 2 |
| ✓ | 3D | 210-038-063 | BW-5619-P50 | | | | 2 | 19 | | | | 50 | 1 | 2 |

BEARINGS

SWIVELS

MULTI-PURPOSE LIDS

VENTILATORS

MULTI-PURPOSE CAPS

GROMMETS

CABLE GROMMETS

GASKET

BELT REEL PARTITION

GLASS POINT FIX

OTHERS

LED LIGHTS

GROMMET NG

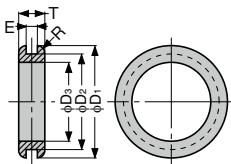

● Flam retardant material (UL94V-0) available by made to order.

| Material | Hardness | Colour |
|----------|----------|--------|
| EPDM | 50° ± 5° | Black |

| RHS | CAD | Item Code | Item Name | D ₁ | D ₂ | D ₃ | E | T | R | Weight (g) | Pack (pcs) | Box (pack) | Carton (pack) | | |
|-----|-----|-------------|--------------|----------------|----------------|----------------|-----|-----|-----|------------|------------|------------|---------------|---|---|
| ✓ | 3D | 210-038-167 | NG-937-P100 | 9 | 6 | 3.5 | 1.2 | 3.7 | 0.6 | 0.5 | 100 | 1 | 5 | | |
| ✓ | 3D | 210-038-149 | NG-1145-P100 | | | | 1.5 | 4.5 | | | 100 | 1 | 5 | | |
| ✓ | 3D | 210-038-150 | NG-1160-P100 | 11 | 8 | 5 | 3 | 6 | | | 0.7 | 100 | 1 | 5 | |
| ✓ | 3D | 210-038-151 | NG-1345-P100 | | | | 1.5 | 4.5 | | | | 100 | 1 | 5 | |
| ✓ | 3D | 210-038-152 | NG-1360-P100 | 13 | 10 | 7 | 3 | 6 | | | | 1 | 100 | 1 | 5 |
| ✓ | 3D | 210-038-153 | NG-1545-P100 | | | | 1.5 | 4.5 | | | | | 100 | 1 | 5 |
| ✓ | 3D | 210-038-154 | NG-1560-P100 | 15 | 12 | 9 | 3 | 6 | 1.5 | 100 | | | 1 | 5 | |
| ✓ | 3D | 210-038-155 | NG-1955-P100 | | | | 1.5 | 5.5 | | 100 | | | 1 | 5 | |
| ✓ | 3D | 210-038-156 | NG-1970-P100 | 19 | 15 | 11 | 3 | 7 | | 1.7 | 100 | | 1 | 5 | |
| ✓ | 3D | 210-038-157 | NG-2155-P100 | | | | 1.5 | 5.5 | | | 100 | | 1 | 5 | |
| ✓ | 3D | 210-038-158 | NG-2170-P100 | 21 | 17 | 13 | 3 | 7 | | | 2 | 100 | 1 | 5 | |
| ✓ | 3D | 210-038-159 | NG-2355-P100 | | | | 1.5 | 5.5 | | | | 100 | 1 | 5 | |
| ✓ | 3D | 210-038-160 | NG-2370-P100 | 23 | 19 | 15 | 3 | 7 | 2.5 | | | 100 | 1 | 5 | |
| ✓ | 3D | 210-038-161 | NG-3065-P100 | | | | 1.5 | 6.7 | | | | 100 | 1 | 5 | |
| ✓ | 3D | 210-038-162 | NG-3080-P100 | 30 | 25 | 20 | 3 | 8 | | 3.5 | | 100 | 1 | 5 | |
| ✓ | 3D | 210-038-163 | NG-3565-P100 | | | | 1.5 | 6.7 | | | | 100 | 1 | 5 | |
| ✓ | 3D | 210-038-164 | NG-3580-P100 | 35 | 30 | 25 | 3 | 8 | | | 5 | 100 | 2 | 5 | |
| ✓ | 3D | 210-038-165 | NG-4275-P50 | | | | 1.5 | 7.5 | | | | 50 | 1 | 2 | |
| ✓ | 3D | 210-038-166 | NG-4290-P50 | 42 | 36 | 30 | 3 | 9 | 8 | | | 50 | 1 | 2 | |